

columbia®  
aqua

FC-950-ROP  
FC-950-F  
FC-950-UF

---

**MT**

---

**Technical Manual  
Service Booklet**

---





## **INDEX**







1. PRINCIPAL CHARACTERISTICS	<b>4</b>
2. TECHNICAL CHARACTERISTICS	<b>5</b>
3. HOW TO GET WATER FROM YOUR DISPENSER	<b>10</b>
4. IDENTIFYING THE MANAGEMENT AND CONTROL COMPONENTS	<b>11</b>
5. USER INTERFACE	<b>12</b>
6. HOW TO ACCESS THE FILTERS	<b>12</b>
7. WARRANTY	<b>14</b>
8. RECORDING SHEET FOR THE INSTALLATION AND STARTING UP OF THE EQUIPMENT. TECHNICIAN	<b>15</b>
9. SERVICE BOOKLET. USER	<b>17</b>
10. NOTES	<b>18</b>

## 1. CARACTERÍSTICAS PRINCIPALES

ROP

F

UF

		ROP	F	UF
	<b>UV LED</b> Ease of access and maintenance	•	•	•
	<b>COLUMBIA FILTERS</b> Fast connection, original Columbia filters	•	•	•
	<b>CAPSULATED MEMBRANE</b> Membrane Installed. Maximum hygiene	•		
	<b>REMINERALIZER</b> Post-filter that adjusts the pH	•		
	<b>CLICK</b> Rapid and highly secure connections	•	•	•
	<b>PRESSURE PUMP</b> Better production and performance	•		
	<b>SOLENOID VALVE</b> Immediate Control.	•		
	<b>REVERSE OSMOSIS</b> Equipment with reverse osmosis system and pump	•		
	<b>FILTER</b> Equipment with filtration system		•	
	<b>ULTRAFILTRATION</b> Equipment with ultrafiltration system			•
	<b>COLD</b> Cold water production	•	•	•
	<b>HOT</b> Hot water production	•	•	•
	<b>SAVE</b> Safety system for hot water	•	•	•
	<b>AMBIENT</b> Production of room temperature water Heat disabler	•	•	•
	<b>LED</b> LED multifunction information system	•	•	•
	<b>ANTIBACTERIA</b> Protector for faucet outlets made of antibacterial plastic. Removable and washable	•	•	•

## 2. TECHNICAL CHARACTERISTICS

Application	
Water Treatment	<ul style="list-style-type: none"> <li>• Reverse osmosis (ROP Model)</li> <li>• Filtration (F Model)</li> <li>• Ultrafiltration (UF Model)</li> </ul>
Use	<ul style="list-style-type: none"> <li>• Mejora de las características del agua potable (que cumpla con los requisitos de la Directiva Europea sobre Agua de consumo humano 98/83 o sus trasposiciones nacionales en los distintos estados miembros de la Comunidad Europea).</li> </ul>

### Modification for reduction or intake

ROP Model	<ul style="list-style-type: none"> <li>• Water treatment through reverse osmosis is able to reduce the concentration of salts and other substances in high percentages.</li> <li>• Minimum reduction* of certain components and parameters:               <ul style="list-style-type: none"> <li>Sodium – 90 %</li> <li>Calcium – 90%</li> <li>Sulphates – 90%</li> <li>Chloride – 90%</li> <li>Overall hardness – 90%</li> <li>Conductivity – 90%</li> </ul> </li> </ul>
-----------	---

[\*] Based on the characteristics of water to be treated (at the outlet of the membrane). These values may vary depending on the type of post-filter used in the equipment.

F Model	<ul style="list-style-type: none"> <li>• The treatment of water through filtration retains all suspended particles that have a diameter larger than 5 microns.</li> <li>• The carbon filter reduces* the flavour and smell of the water, as well as its organic components.</li> </ul>
---------	--

[\*] Based on the characteristics of the water to be treated.

UF Model	<ul style="list-style-type: none"> <li>• This equipment comprises a first Filtration stage.</li> <li>• The treatment of water through Ultrafiltration is able to retain suspended particles that have a diameter between 0,1 and 0,0001 microns.</li> </ul>
----------	---

[\*] Based on the characteristics of the water to be treated.

Operational Limit			
	ROP	F	UF
Pressure (max. / min.)	2,5 bar (250 kPa) 1 bar (100 kPa)	5 bar (500 kPa) 1 bar (100 kPa)	5 bar (500 kPa) 1 bar (100 kPa)
TDS (max.)	2000 ppm	-	-
Temperature (max. / min.)	40°C – 2°C	40°C – 2°C	40°C – 2°C
Hardness (max.)	15°HF**	-	-
Technical			
Control Type:	Level switch. Inlet Solenoid Valve. Cold Water Thermostat. Hot Water Thermostat.	Cold Water Thermostat. Hot Water Thermostat.	Cold Water Thermostat. Hot Water Thermostat.
Security System:	Security heat shield for hot water. Anti-spill Float valves.	Security heat shield for hot water. Anti-spill Float valves.	Security heat shield for hot water. Anti-spill Float valves.
Inlet connection:	1/4"	1/4"	1/4"
Drainage Connection:	1/4"	-	-
Wall adapter:	3/8"	3/8"	3/8"
Drain saddle:	40 mm clamp for the drainage tube	-	-

	<b>ROP</b>	<b>F</b>	<b>UF</b>
<b>Treatment:</b>	1 Sediment Prefilter 1 Carbon Prefilter 1 RO 80 GPD Membrane 1 Postfilter to adjust pH	1 Sediment Prefilter 1 Carbon Prefilter	1 Sediment Prefilter 1 Carbon Prefilter 1 Ultrafiltration cartridge

**Pre and Prefilter Connections :**

Inlet: 1/4" spike

Outlet: 1/4" spike

**Membrane Connection**

Inlet: 1/4" spike

Outlet (RO): 1/4" spike

Rejection (R): 1/4" spike



**Dimensions:** [A x B x C] 1100 x 260 x 360  
**Weight:** 23 kg

**TOTAL TANK VOLUME**

**Cold water tank:**

3,7 liters. This volume is reduced to 2,7 liters if it includes a floating valve.

**Hot water tank:**

1,8 liters.

**Inlet Connection:** 1/4"  
**Drain Connection:** 1/4"  
**Power supply:** 220 – 240 Vac

**REFRIGERATION SYSTEM**

**Compressor :** 1/11 CV seal  
**Compressor's Power:** 90 W  
**Capacitor:** Capillary type  
**Refrigerating gas:** R134A  
**Temperature control:** Capillary thermostat

**HEATING SYSTEM**

**Heater:** Band Heater  
**Heater's Power:** 300 W  
**Temperature Control:** Bi-metal auto-buildable  
**Overheating Protection:** Bi-metal auto-buildable

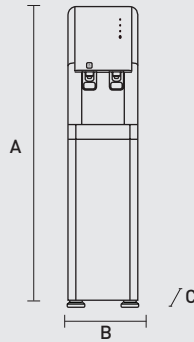

**HYDRAULIC SCHEME - ROP MODEL**

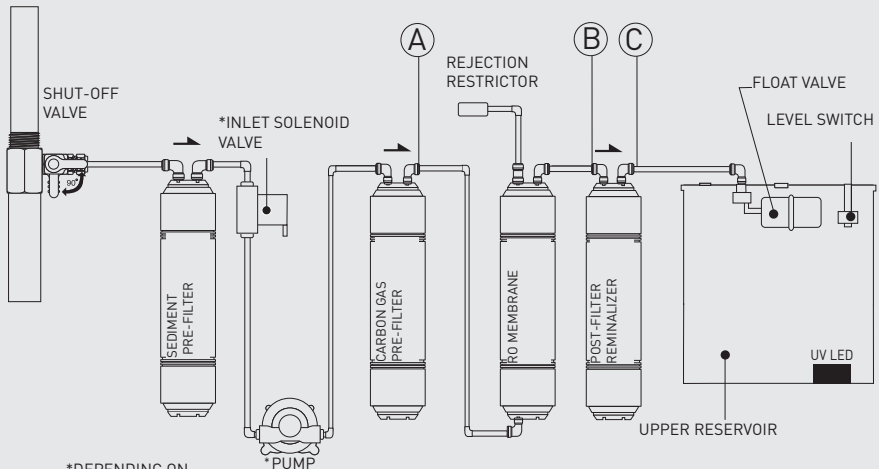

\*DEPENDENT ON THE MODEL

## HYDRAULIC SCHEME - F MODEL

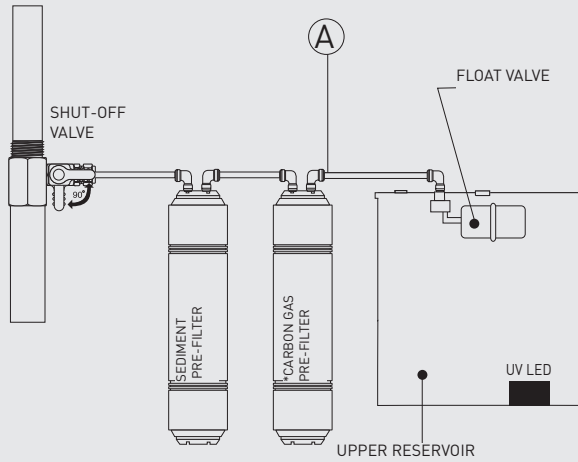

## HYDRAULIC SCHEME - UF MODEL

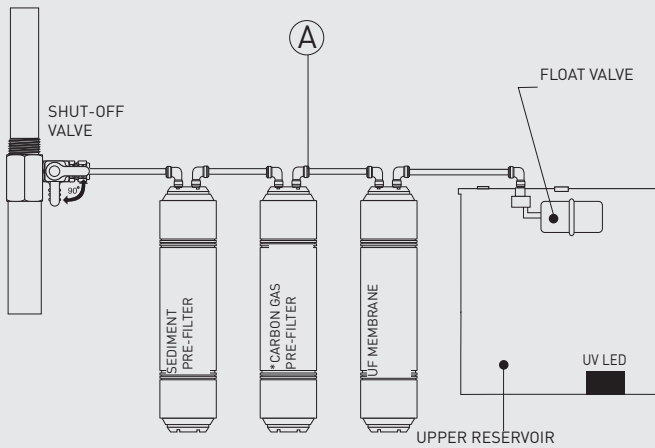

### ELECTRIC SCHEME - ROP MODEL

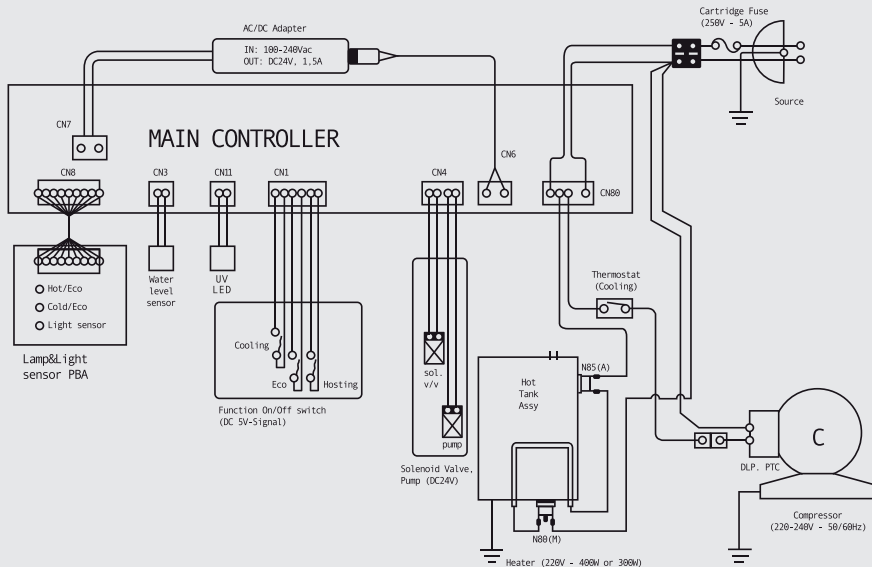

### ELECTRIC SCHEME - UF AND F MODELS

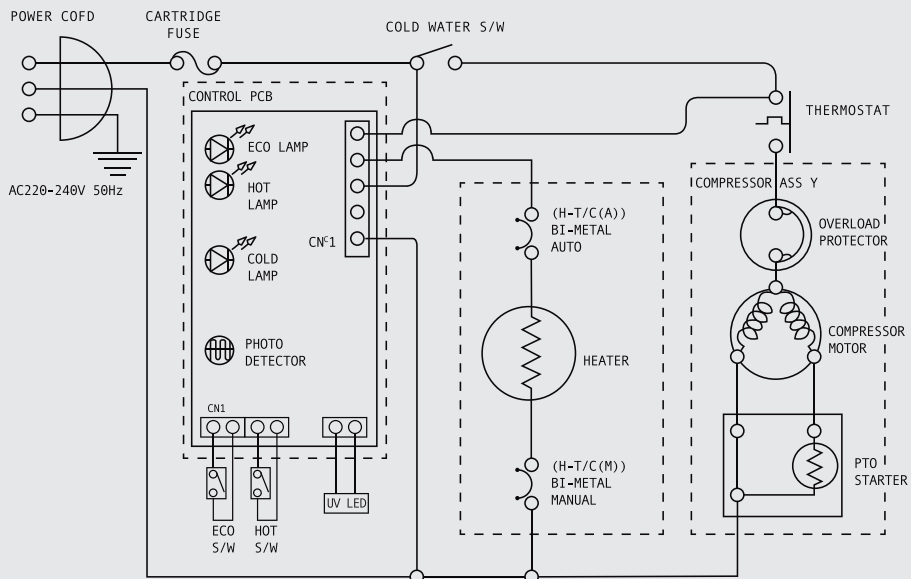



**ROP MODEL HYDRAULIC CONNECTION SCHEME**

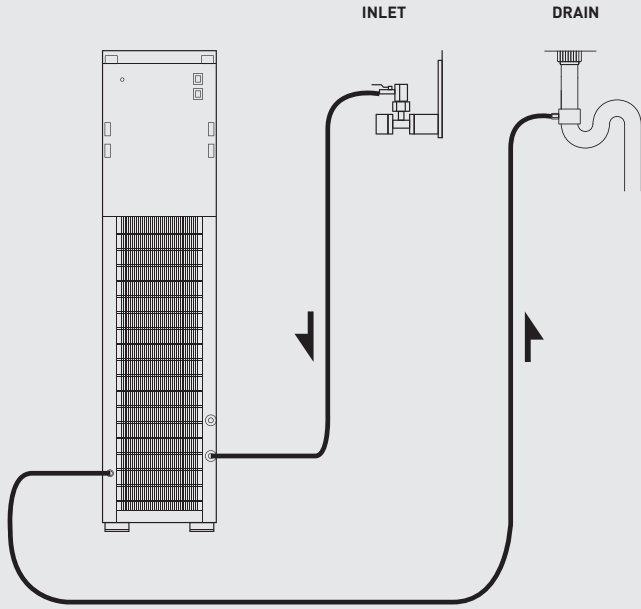

**U & UF MODELS HYDRAULIC CONNECTION SCHEME**

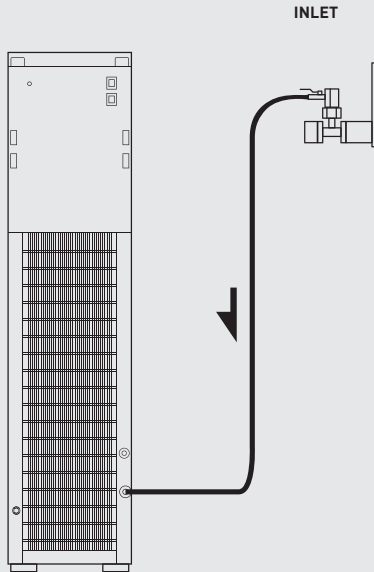

### 3. HOW TO GET WATER FROM THE DISPENSER

- To get cold water: Press with the cup the right lever of the dispenser so that cold water begins to flow [1]
- To get hot water: Press the button with the padlock icon while you push the lever on the left with your cup so that hot water begins to flow [2]

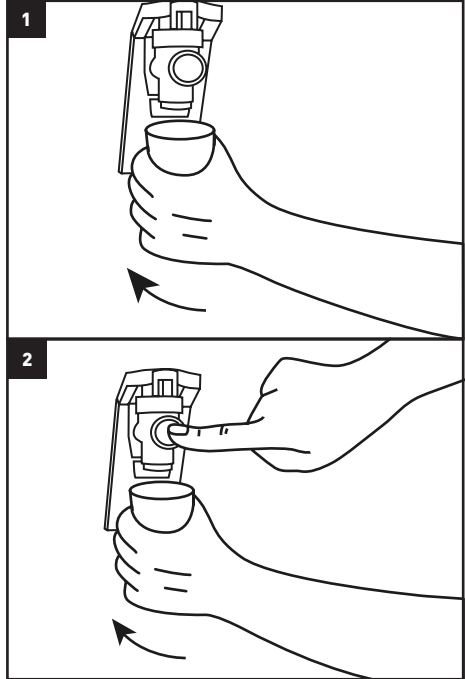

## 4- IDENTIFYING THE MANAGEMENT AND CONTROL COMPONENTS

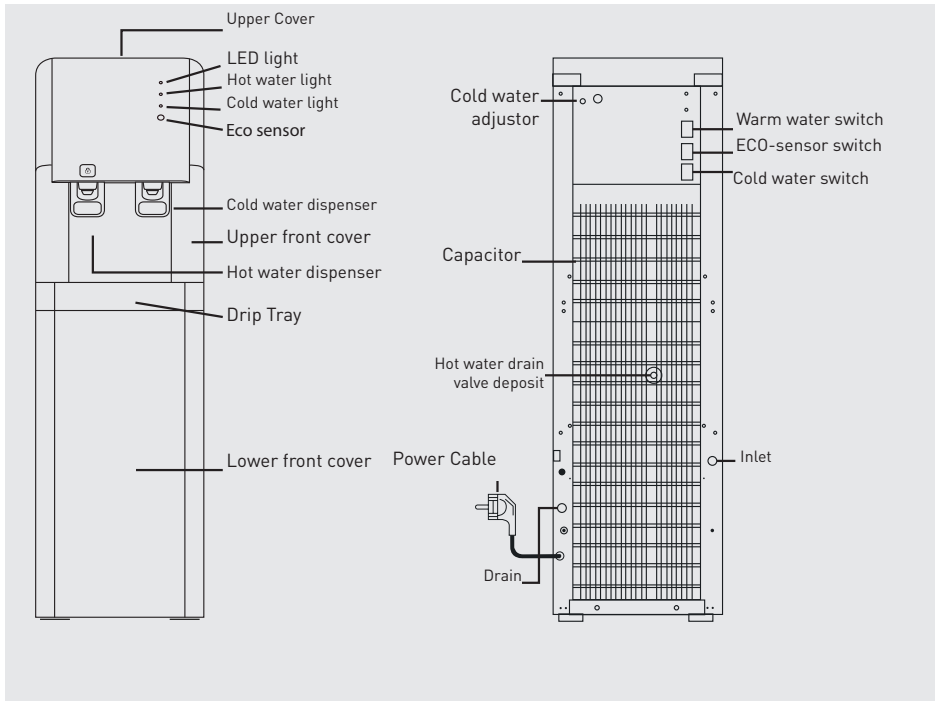

### Hot water light

Indicates the states of the hot water system, as well as the state of the energy saving system. See point 5 (User interface).

### ECO-Sensor

The equipment includes a light sensor that, when the Energy Saver mode is activated through the rear switch, it allows the equipment to work at full capacity while it receives light and, once it is dark (at night) it switches the equipment into energy saving mode.

### Cold water indicator

When green, it indicates that the cold water mode is activated.

### Hot water dispenser

It includes the security system. See point 3 (How to extract water from your dispenser).

### Drip tray. Discharge.

Periodically remove the tray to empty it of possible drips after water withdrawals, in order to prevent overflow. To do this, hold the tray with both hands and pull it slightly back.

### Cold water light

When green, it indicates that the cold water mode is activated.

### Lower front cover. Accessing the filters.

Remove the drip tray and remove the visible screw. Hold the lower front cover with both hands and separate it from the equipment while pulling it slightly down..

### Adjustable feet

Level the equipment using the adjustable feet.

### Hot water switch.

Turn the switch to the ON position to activate the water heating system. If it is kept in the OFF position, the system will dispense water at room temperature through the red dispenser.

### ECO sensor switch.

Turn the switch to the ON position to activate the power saving mode.

### Thermostat cooling system

Adjust the cold water temperature using the rear thermostat. It can be regulated between 3°C (-°C) to 10°C (+°C).

### Hot water drain valve deposit.

Unscrew the cap to completely empty the hot water tank during sanitization and maintenance.

### UV lamp indicator

Indicates that the UV lamp of the cold water tank is operating correctly.

## 5. USER INTERFACE

The equipment features light indicators placed over hot and cold-water dispensers to indicate the equipment's various states.

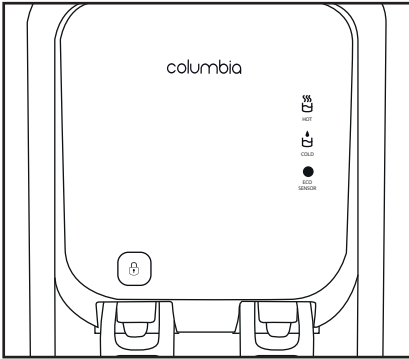

LED lamp operation indicator



If the indicator above the cold water dispenser (COLD) is green, it indicates that the cooling system is activated.



The indicator located on the hot water dispenser (HOT), has 3 states that combine the different positions of the hot water system and energy saving system switches.

If the HOT indicator is off, it indicates that the HOT rear switch is in the OFF position and therefore the device will not provide hot water.

If the HOT indicator is red, it indicates that the hot water system is active and the energy saving system is deactivated.

If the HOT indicator is amber, it indicates that the hot water system is activated and the energy saving system is also activated.

If the HOT indicator is green, it indicates that both hot water and energy saving systems are activated and the light sensor, once it detects that it is evening, has turned off the hot water system.

## 6. HOW TO ACCESS THE FILTERS

Hold the lower front cover with both hands and separate it from the equipment while pulling it down slightly.

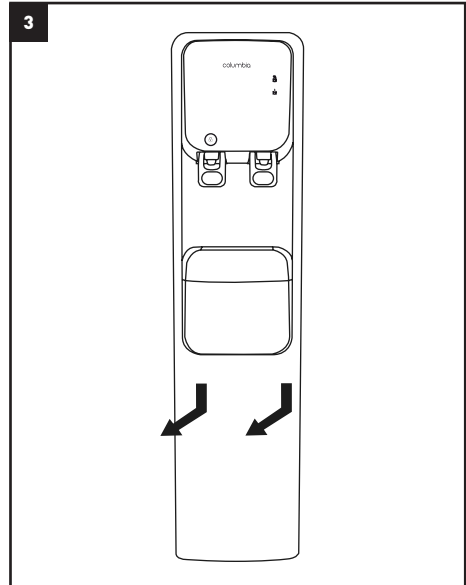



## 17. WARRANTY

### EQUIPMENT WARRANTY ADDRESSED TO THE END-USER:

The distributor guarantees the equipment for a period of two years for any lack of conformity detected and as pursuant to RD 1/2007 of 16 November (Consolidated text of the General Law for the Defence of Consumers and Users). The warranty provides for the reparation and substitution of defective pieces by personnel authorised by the Distributor or the Technical Assistance Service (TAS), wherever they have been installed or in their workshops. The warranty covers any labour and shipment fees that may be incurred.

B-60326279 is exempt from this warranty if the parts are subject to natural wear, lack of maintenance, blows or other lack of conformity that result from the improper use of the equipment or its inadequate use considering the operational limits indicated by its manufacturer. The warranty is also invalidated in cases of improper manipulation and use of the equipment, or when the equipment has been modified or repaired by personnel not employed by the distributor or the official TAS. The parts replaced under warranty will remain property of B-60326279.

B-60326279 responds for the lack of conformity of the equipment when there are issues with the origin, identity or suitability of the products, in accordance with their nature and purpose.

Taking into account the characteristics of the equipment, if the warranty is to cover any lack of conformity, compliance the technical installation and operation conditions of this warranty sheet is essential; as is a copy of the invoice or purchase ticket. If these conditions are not fulfilled, it may lead to the invalidation of the warranty, taking into account the equipment's purpose and the conditions and operating limits in which it must operate.

The distributor guarantees that the equipment installed is suitable in particular for the improvement of the quality of the water to be treated, based on the characteristics of the equipment and all applicable laws.

The installer and/or distributor guarantees the correct installation and implementation of the equipment as indicated by the manufacturer and applicable law and will also respond for any lack of conformity that may result from the incorrect application, instalment or implementation of the equipment.

For any warranty claims it is necessary to present the purchase invoice. The 2-year period is calculated from the day the equipment was purchased from the distributor.

If during the warranty period your equipment presents any issues, contact your distributor.

**If the equipment to be installed will treat water with a hardness quotient higher than 250F, B-60326279 will not be responsible for any damages, malfunctioning or any consequences provoked by the characteristics of the water.**

AUTHORISED COMPANY AND/OR INSTALLER: (date and signature)

### The equipment was installed and functions satisfactorily for the client and for the record:

\*Pre-treatment to RO equipment:

### Results of the Installation Data Sheet and Start-up:

CORRECT

OTHER

The owner of the equipment has been informed adequately and clearly of the use, manipulation and maintenance that the equipment requires to guarantee its correct operation and the quality of the water produced. For this reason, we offer you a maintenance contract.

### \*Ref. Maintenance Contract:

ACCEPTS the maintenance contract

DOES NOT ACCEPT the maintenance contract

If you need information, or if you need to communicate any damages, maintenance requests or request the intervention of a technician, first read the operational, detection and problem shooting sections of this manual and get in touch with the distributor or the company that sold your equipment.

### NOTE FOR THE COMPANY AND/OR THE AUTHORISED TECHNICIAN/INSTALLER:

The data marked with (\*) must be filled by the installing technician

Serial number:

**18. RECORD SHEET FOR THE INSTALLATION AND COMMISSIONING OF THE EQUIPMENT. TECHNICIAN**

**NOTES FOR THE TECHNICIAN/INSTALLER:** Read this Manual carefully. If you have any doubts, get in touch with the Technical Assistance Service (T.A.S.) of your distributor. The data marked with (\*) must be filled by the installing technical and transcribed in the WARRANTY SHEET. This sheet must be preserved by the installer/distributor and may be required by IF/PEU/PAM\* for the purpose of improving after-sale and customer service. The technician that performs the installation and set-up of the equipment must be in possession of the appropriate skills.

**COMMENTS:**  
 Results of the installation and set-up:  
 CORRECT (equipment installed and functioning correctly. Water produced can be used).  
 OTHERS: \_\_\_\_\_  
 \_\_\_\_\_

Serial number: \_\_\_\_\_  
 \_\_\_\_\_  
 \_\_\_\_\_  
 \_\_\_\_\_  
 \_\_\_\_\_

**Identification of the Authorized Technician/Installer**  
 \_\_\_\_\_  
 Company and/or installer, date and signature  
 \_\_\_\_\_  
 \_\_\_\_\_

**DATA OVER THE APPLICATION OF THE EQUIPMENT**  
 Source of the water to be treated:  
 Public Supply Network  
 \*Pre-treatment to the equipment \_\_\_\_\_  
 \*Inlet hardness RO equipment [oF] \_\_\_\_\_  
 \*Inlet TDS in RO equipment [ppm] \_\_\_\_\_  
 \*Inlet Pressure in RO equipment [bar] \_\_\_\_\_  
 \*Chloride Concentration [ppm] \_\_\_\_\_

**Confirmation of the Equipment's Owner**  
 I have been clearly informed of the use, manipulation and maintenance that the installed equipment requires and I have been offered a maintenance contract and informed of how to contact Customer Service if I need information, if I need to notify any damages or malfunctioning, request a maintenance service or request the intervention of a technician.  
 Comments: \_\_\_\_\_  
 \_\_\_\_\_

**Installation Check-List**  
 Cleaning of carbon filters.  
 Cleaning of carbon post-filters.  
 Sanitization according to the described protocol  
 Revision and Fitting  
 Verifying of the pressurized system  
 TDS of the produced water [ppm] \_\_\_\_\_  
 The customer has been clearly informed of the use, manipulation and maintenance that the equipment requires to guarantee its correct operation and the quality of water procured. Taking into account the importance that a correct maintenance of the equipment holds to guaranteeing the quality of the water produced, the owner must be offered a maintenance contract carried out by properly trained technicians

**\*Ref. Maintenance Contract** \_\_\_\_\_  
 ACCEPTS the maintenance contract  
 DOES NOT ACCEPT the maintenance contract  
 Model / Ref. \_\_\_\_\_  
 Owner (Mr/Ms) \_\_\_\_\_  
 \_\_\_\_\_  
 Street: \_\_\_\_\_  
 \_\_\_\_\_  
 Phone No.: \_\_\_\_\_  
 \_\_\_\_\_  
 Population: \_\_\_\_\_  
 Province: \_\_\_\_\_ ZIP: \_\_\_\_\_

Date and Signature  
 \_\_\_\_\_  
 \_\_\_\_\_

**19. EQUIPMENT INSTALLATION AND COMMISSIONING RECORD SHEET. TECHNICIAN**



DATE	TYPE OF SERVICE	NAME, SIGNATURE AND SEAL OF THE AUTHORIZED TECHNICIAN	
/ /	<input type="checkbox"/> SET-UP	TECHNICIAN	
/ /	<input type="checkbox"/> FULL MAINTENANCE	SEAL	
/ /	<input type="checkbox"/> REPARATION		
/ /	<input type="checkbox"/> SANITIZATION		
/ /	<input type="checkbox"/> OTHER		
/ /	<input type="checkbox"/> FULL MAINTENANCE		
/ /	<input type="checkbox"/> REPARATION	SEAL	
/ /	<input type="checkbox"/> SANITIZATION		
/ /	<input type="checkbox"/> OTHER		
/ /	<input type="checkbox"/> FULL MAINTENANCE		
/ /	<input type="checkbox"/> REPARATION	SEAL	
/ /	<input type="checkbox"/> SANITIZATION		
/ /	<input type="checkbox"/> OTHER		
/ /	<input type="checkbox"/> FULL MAINTENANCE		
/ /	<input type="checkbox"/> REPARATION	SEAL	
/ /	<input type="checkbox"/> SANITIZATION		
/ /	<input type="checkbox"/> OTHER		
/ /	<input type="checkbox"/> FULL MAINTENANCE		
/ /	<input type="checkbox"/> REPARATION	SEAL	
/ /	<input type="checkbox"/> SANITIZATION		
/ /	<input type="checkbox"/> OTHER		
/ /	<input type="checkbox"/> FULL MAINTENANCE		
/ /	<input type="checkbox"/> REPARATION	SEAL	
/ /	<input type="checkbox"/> SANITIZATION		
/ /	<input type="checkbox"/> OTHER		
/ /	<input type="checkbox"/> FULL MAINTENANCE		
/ /	<input type="checkbox"/> REPARATION	SEAL	
/ /	<input type="checkbox"/> SANITIZATION		
/ /	<input type="checkbox"/> OTHER		
/ /	<input type="checkbox"/> FULL MAINTENANCE		



**19. SERVICE BOOKLET. USER**

DATE	TYPE OF SERVICE	NAME, SIGNATURE AND SEAL OF THE AUTHORIZED TECHNICIAN	
/ /	<input type="checkbox"/> SET-UP	TECHNICIAN	
/ /	<input type="checkbox"/> FULL MAINTENANCE	SEAL	<input type="checkbox"/> ORDINARY
/ /	<input type="checkbox"/> REPAIRATION		<input type="checkbox"/> EXTRAORDINARY
/ /	<input type="checkbox"/> SANITIZATION		<input type="checkbox"/> WARRANTY
/ /	<input type="checkbox"/> OTHER		
/ /	<input type="checkbox"/> FULL MAINTENANCE		TECHNICIAN
/ /	<input type="checkbox"/> REPAIRATION	SEAL	<input type="checkbox"/> EXTRAORDINARY
/ /	<input type="checkbox"/> SANITIZATION		<input type="checkbox"/> WARRANTY
/ /	<input type="checkbox"/> OTHER		
/ /	<input type="checkbox"/> FULL MAINTENANCE		TECHNICIAN
/ /	<input type="checkbox"/> REPAIRATION	SEAL	<input type="checkbox"/> EXTRAORDINARY
/ /	<input type="checkbox"/> SANITIZATION		<input type="checkbox"/> WARRANTY
/ /	<input type="checkbox"/> OTHER		
/ /	<input type="checkbox"/> FULL MAINTENANCE		TECHNICIAN
/ /	<input type="checkbox"/> REPAIRATION	SEAL	<input type="checkbox"/> EXTRAORDINARY
/ /	<input type="checkbox"/> SANITIZATION		<input type="checkbox"/> WARRANTY
/ /	<input type="checkbox"/> OTHER		
/ /	<input type="checkbox"/> FULL MAINTENANCE		TECHNICIAN
/ /	<input type="checkbox"/> REPAIRATION	SEAL	<input type="checkbox"/> EXTRAORDINARY
/ /	<input type="checkbox"/> SANITIZATION		<input type="checkbox"/> WARRANTY
/ /	<input type="checkbox"/> OTHER		
/ /	<input type="checkbox"/> FULL MAINTENANCE		TECHNICIAN
/ /	<input type="checkbox"/> REPAIRATION	SEAL	<input type="checkbox"/> EXTRAORDINARY
/ /	<input type="checkbox"/> SANITIZATION		<input type="checkbox"/> WARRANTY
/ /	<input type="checkbox"/> OTHER		
/ /	<input type="checkbox"/> FULL MAINTENANCE		TECHNICIAN
/ /	<input type="checkbox"/> REPAIRATION	SEAL	<input type="checkbox"/> EXTRAORDINARY
/ /	<input type="checkbox"/> SANITIZATION		<input type="checkbox"/> WARRANTY
/ /	<input type="checkbox"/> OTHER		
/ /	<input type="checkbox"/> FULL MAINTENANCE		TECHNICIAN





**MT**